

Honeywell's Dolphin 9500 Trade-In Program

Honeywell announced a new program to help Dolphin 9500 customers upgrade to the next-generation Dolphin 9900 mobile computer. This simple program will provide customers that purchase 9900 units with a cash incentive for each working 9500 unit that is traded in.

Designed to provide customers with the benefits of complete life cycle management, the upgrade program helps customers maintain their current investments in software, training and infrastructure, such as accessories, cables and peripherals, while also supporting a path for future expansion. In addition, the 9900's form factor and usability is nearly identical to that of its predecessor, ensuring familiarity and ease-of-use.

The ergonomic and extremely durable Dolphin 9900 is purpose-built for applications in harsh environments that require reliable barcode scanning and keypad data entry. Designed with durability in mind, the Dolphin 9900 is IP64-rated and can withstand multiple five-foot drops to concrete and more than 2,000 three-foot tumbles. This next-generation device provides current Dolphin 9500 users with important upgrades, including built-in GPS technology and Microsoft's latest operating system—Windows Mobile 6.1. The Dolphin 9900 also incorporates Honeywell's proprietary Shift-PLUS power management technology, which provides 10+ hours of battery life, eliminating the need to replace batteries during most work shifts.

www.honeywellaidc.com/9500tradein

Packaging Industry Alignment for Mobile-Enabled Interactive Packaging

DuPont Packaging & Industrial Polymers (P&IP) announced it has successfully engaged some of the most prominent packaging providers in the industry around the use of mobile-enabled, two-dimensional (2D) barcode technology, including Graphics Packaging, Inc. and Printpack, Inc., while also making its learnings in packaging clear to the Open Mobile Alliance (OMA). A key element in this, based on DuPont's efforts with Scanbuy over the past two years, is Scanbuy's globally interoperable ScanLife mobile enabled 2D EZcode system, which has features particularly well-suited for packaging and a wide breadth in the number of phones it operates with.

With the technology from Scanbuy, a Consumer Packaged Goods (CPG) marketer can place a 2D barcode on any packaging material to quickly connect consumers to additional product information, coupon offers or promotional content like recipe ideas — effectively making the traditional package interactive. A user simply scans the code with a camera phone to

access the content in one click rather than searching for content by keyword or typing in a long URL on their mobile phone.

The ScanLife mobile application is being preloaded on millions of new phones in Europe, North America and Latin America — making it a practical utility for consumers. While the system can read all major code formats, the EZcode offers a number of features that are critical for the packaging industry: strong performance in small footprint areas (as small as one-half inch square) and low-light environments as well as consistent compatibility with low-resolution camera phones. The format was originally developed by ETH Zurich, and licensed to Scanbuy, Inc. who has released the specifications to the public. www2.dupont.com

TGW-ERMANCO Introduces Larger AS/RS Commissioner

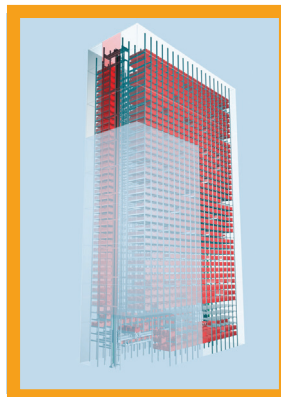

TGW-ERMANCO has added the Commissioner XL to its AS/RS product line. At 60' high and 38' deep, the XL is 50% taller and 80% longer than the original Commissioner. Offering the XL in two sizes allows the specific requirements of an operation to be met most efficiently.

The Commissioner XL is a compact, high-performance, vertical storage/sortation system that provides order fulfillment and sortation capabilities in ambient, refrigerated and freezer environments. It is ideally suited for WIP buffering, product staging, order consolidation, order picking, and sortation prior to shipping or palletizing. Applications of the XL include route stop sequencing, store aisle sequencing or sequencing products for palletizing.

A lifting beam design is the basis for the optimal storage utilization with high-throughput capability achieved by the Commissioner XL. The load handler stores and retrieves loads by traveling horizontally along the lifting beam, which moves up and down to the correct storage position in the Commissioner XL. Typically integrated into a system, the Commissioner XL can be used as a single unit or multiple units. When multiple units are integrated, routine maintenance can be performed on one Commissioner without interrupting the workflow.

TGW-ERMANCO is a provider of integrated material handling systems and is a member of the worldwide TGW Logistics Group. www.tgw-group.com ■